

SPARE PARTS SECTION

The following section covers the spare parts diagrams and lists that were current at the time this manual was originally printed. Due to continuous improvements of the machine, changes may be made at any time without notification.

HOW TO ORDER SPARE PARTS

1. Have your machines **model number, serial number & date of manufacture** on hand, these can be found on the specification plate mounted on the machine
2. A scanned copy of your parts list/diagram with required spare part/s identified
3. Go to www.machineryhouse.com.au/contactus and fill out the enquiry form attaching a copy of scanned parts list.

CONTENTS

| | |
|--------------------------|----|
| B.HeadBodyPartsList..... | 21 |
| C. TableColumnList..... | 23 |



OPERATION MANUAL

B. HEAD BODY PARTS LIST

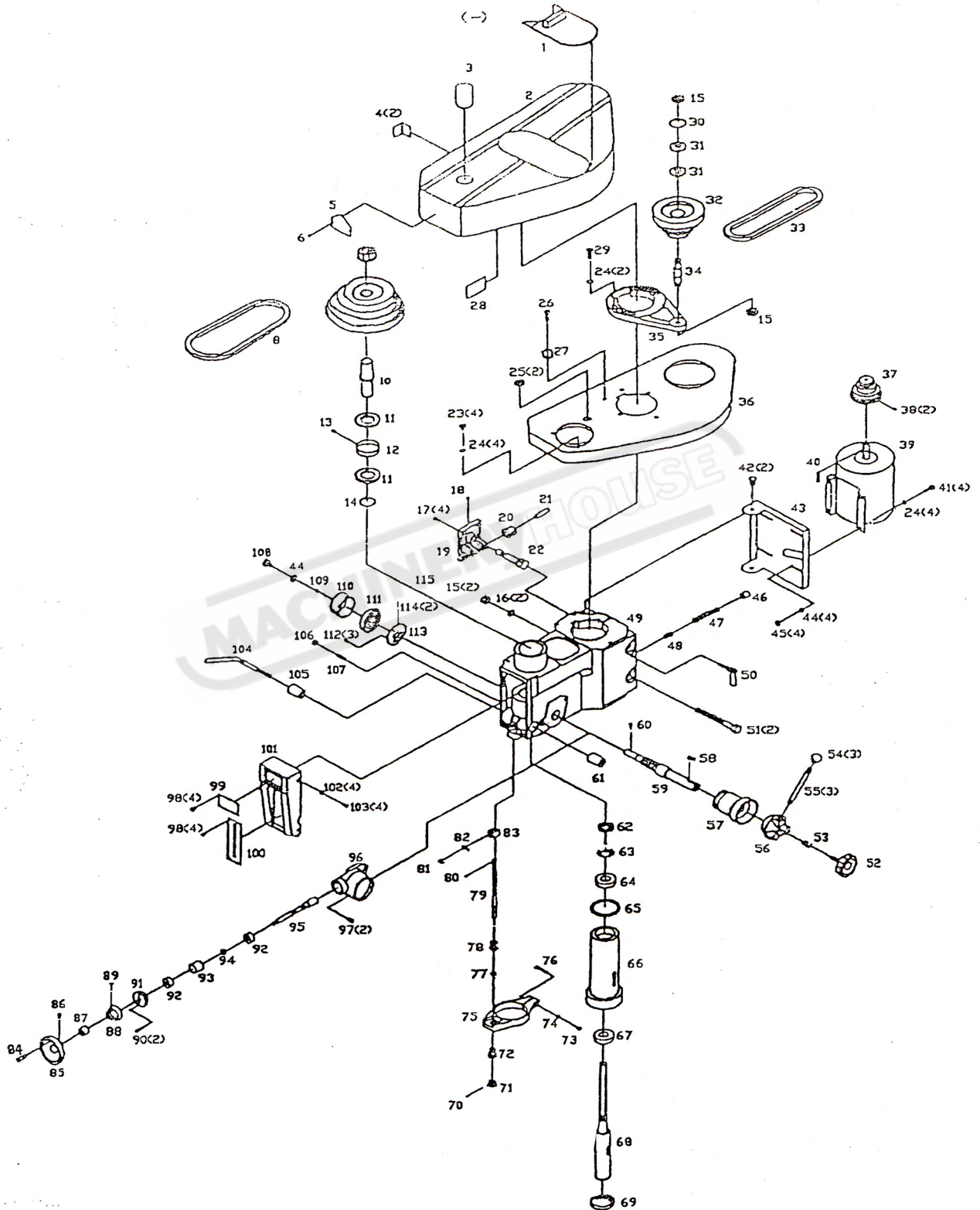

OPERATION MANUAL

B. HEAD BODY PARTS LIST

| NO. | NAME | NO. | NAME | NO. | NAME |
|-----|---------------------|-----|---------------------|-----|---------------------|
| 1 | cover board | 39 | motor | 77 | nut |
| 2 | up cover | 40 | key | 78 | fixed nut |
| 3 | round | 41 | bolt | 79 | adjustable rod |
| 4 | jaw | 42 | bolt | 80 | pin |
| 5 | trademark | 43 | motor rack | 81 | screw |
| 6 | rivet | 44 | washer | 82 | referral-board |
| 7 | nut | 45 | nut | 83 | stop lump |
| 8 | V-belt | 46 | balata jacketing | 84 | turn handle |
| 9 | spindle ring | 47 | tension pin | 85 | small hand wheel |
| 10 | splined sleeve | 48 | spring | 86 | screw |
| 11 | ball bearing | 49 | spindle box | 87 | adapter sleeve |
| 12 | separating ring | 50 | tight handle | 88 | graduation plate |
| 13 | screw | 51 | bolt | 89 | screw |
| 14 | retaining ring | 52 | big ripple handle | 90 | bolt |
| 15 | nut | 53 | spring | 91 | end lid |
| 16 | washer | 54 | handle ball | 92 | ball bearing |
| 17 | screw | 55 | handle rod | 93 | separating ring |
| 18 | oil cup | 56 | handle body | 94 | retaining ring |
| 19 | bracket | 57 | turbine | 95 | feed worm |
| 20 | gear | 58 | key | 96 | feed inst. support |
| 21 | shaft | 59 | gear shaft | 97 | bolt |
| 22 | worm | 60 | screw | 98 | screw |
| 23 | bolt | 61 | fixed collar thread | 99 | nameplate |
| 24 | washer | 62 | nut | 100 | scale |
| 25 | separating ring | 63 | washer | 101 | front cover board |
| 26 | screw | 64 | ball bearing | 102 | washer |
| 27 | wire californium | 65 | retaining | 103 | screw |
| 28 | warning board | 66 | sleeve | 104 | handle rod |
| 29 | bolt | 67 | ball bearing | 105 | fixed tight collar |
| 30 | retaining ring | 68 | spindle | 106 | nut |
| 31 | ball bearing | 69 | ball bearing lid | 107 | screw |
| 32 | middle pulley | 70 | pin | 108 | small ripple handle |
| 33 | V-belt | 71 | knob | 109 | washer |
| 34 | middle pulley shaft | 72 | locating sleeve | 110 | spring cap |
| 35 | pulley support | 73 | nut | 111 | spring plate |
| 36 | down cover | 74 | washer | 112 | screw |
| 37 | motor pulley | 75 | feed support | 113 | shaft sleeve |
| 38 | screw | 76 | bolt | 114 | pin |



OPERATION MANUAL

C. TABLE COLUMN PARTS LIST

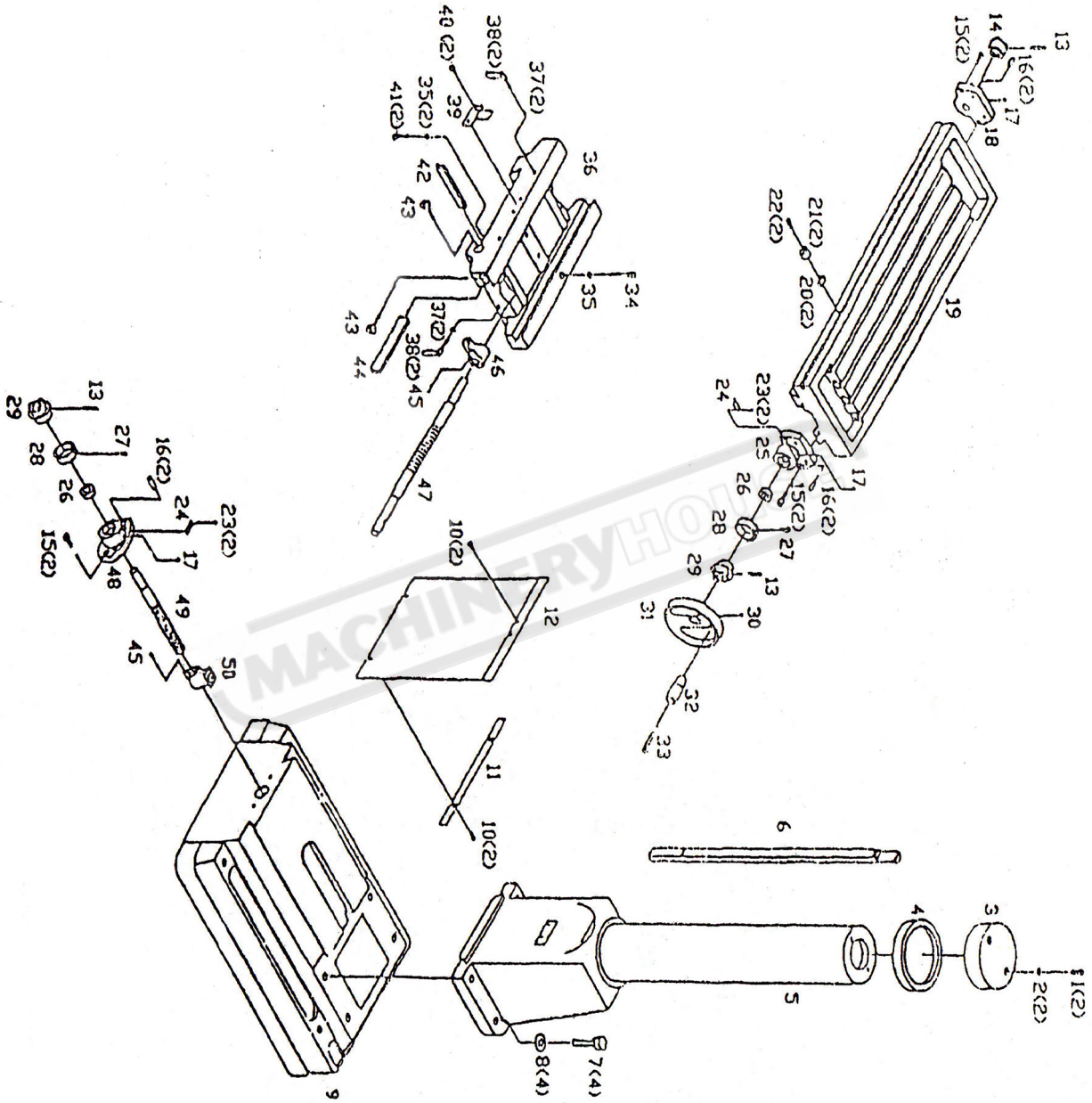

OPERATION MANUAL

C. TABLE COLUMN PARTS LIST

| NO. | NAME | NO. | NAME |
|------------|---------------------|------------|---------------------|
| 1 | Screw | 26 | Ball Bearing |
| 2 | washer | 27 | Screw |
| 3 | Column Lid | 28 | Graduatiot Plate |
| 4 | Link | 29 | Dial Clutch |
| 5 | Column | 30 | screw |
| 6 | Rack | 31 | Hand Wheel |
| 7 | Bolt | 32 | Turn Handle |
| 8 | Washer | 33 | Screw |
| 9 | Base | 34 | Screw |
| 10 | Bolt | 35 | Washer |
| 11 | Protect Board Slice | 36 | Slip Saddle |
| 12 | Protect Board | 37 | Steel Ball |
| 13 | Pin | 38 | Lock Handle |
| 14 | Left Diai Clutch | 39 | Stop Lump |
| 15 | Screw | 40 | Bolt |
| 16 | Pin | 41 | Screw |
| 17 | Oil Cup | 42 | Gib Srrip |
| 18 | Left Support | 43 | Gib Srrip Screw |
| 19 | Table | 44 | Gib Srrip |
| 20 | Ladder-Shaped Nud | 45 | Screw |
| 21 | Stop Lump | 46 | Guide Screw Nut |
| 22 | Screw | 47 | Guide Screw |
| 23 | Rivew | 48 | Guide Screw Support |
| 24 | Zero Site Board | 49 | Guide Screw |
| 25 | Right Support | 50 | Guide Screw Nut |